

ALUPURE ALUMINIUM SYSTEMS



MAJESTIC

Sleek Interlock Sliding Door System



PEOPLE PASSION PROFILES

profine India, a 100% subsidiary of profine GmbH-represented globally, is characterized by quality thinking, innovative strength, efficient processes and responsibility. The pursuit of excellence in all areas is our driving force. What really set us apart is not just the quality but also the technical support that we offer and focus on customer satisfaction. The close partnership with our customers is the foundation of our success.

The goalposts keep changing and the requirements keep growing - the challenges faced by window specialists are becoming more complex. Our services take the pressure off from our window partners so that they can concentrate on the success of their business. With innovative new generation window and door systems, we set new standards in international markets and meet people's needs of brightly lit residential and work spaces. We create the conditions for modern and energy efficient architecture. We provide optimized sound insulation for quiet and stress-free living spaces and create a healthy atmosphere using forward-looking systems.

We take our commitment to being close to the customers; we have our presence across the country. This local presence allows us to understand the requirements of the market and provide the best support to our customers. Another advantage of our close proximity is that we can deliver fast. Our efficient system ensure product arrive at the right place and time.



MAJESTIC – THE SLEEK INTERLOCK SLIDING DOOR SYSTEM

Engineered with German precision, Majestic - the sleek interlock sliding door system is a blend of Elegance and Innovation. Less visible frame, more glass opening for unobstructed view and contemporary designs, transform your living space into a place you can dream of. The sleekness of the interlock creates an illusion of no boundary between indoor and outdoor and transforms the space into impressive property.

The system is being designed in accordance with the Indian building requirements and weather conditions to match the aesthetic desire of all classes. The salient features and engineering of this system makes it an epitome of performance, durability and aesthetics. The system outperforms the performance parameters like high wind load, water penetration and air infiltration which makes it the preferred choice amongst architects, builders and fenestration consultants. The flexibility of height and width further enhances its usability for any premises be it residential apartments, villas, commercial complexes, hotels and institutions.

Majestic, a technically advanced sliding door system which is a result of market response to our other existing systems. If you are looking for a system with high performance, functionality, security with durability and aesthetic appeal, Majestic is the solution you can count on.



Majestic, Sliding Door System is a combination of extraordinary performance and great aesthetics with minimal to no maintenance over their long service life.

Salient Features:

- Sleek and affordable premium interlock sliding door system for all classes
- Maximum shutter size 1.5 x 3 mtr
- Glass thickness SG and DGU upto 32 mm
- 2 track and 3 track frame with SS guide rail and inside lip
- Sleek fly mesh sash with transom optional
- Sleek interlock width 33 mm, depth 120 mm
- Rollers can bear the load upto 300 kg
- Multiple locking to ensure higher security
- Available in multiple colour options
- Low maintenance, eco-friendly and non-flammable
- Durable, comes with 10 years warranty

Quality Standards

Tests	Standards	Result
Air Infiltration	EN 12207	Class 3A
Static Water Penetration	EN 12208	Class 7A
Wind Load Performance	EN12210	Upto 2.5 kpa load



2 Track Sliding Door System

Top Vertical Cross Section

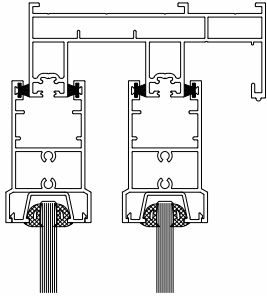

Side Cross Section

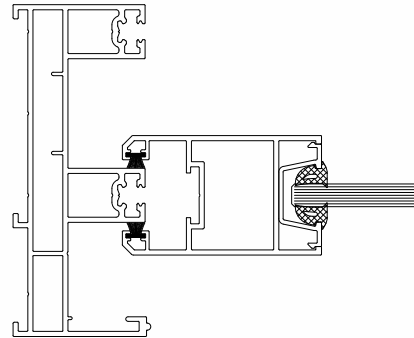

Bottom Vertical Cross Section

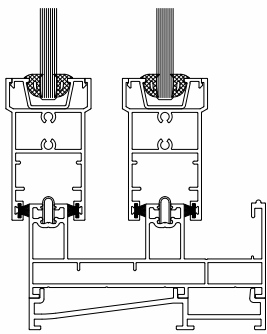

2.5 Track Sliding Door System with Narrow Mesh

Top Vertical Cross Section

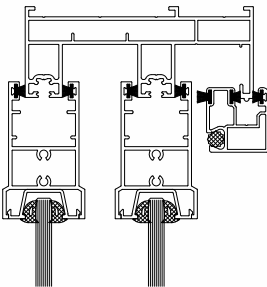

Side Cross Section

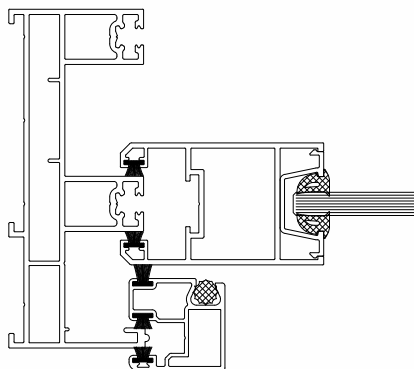

Bottom Vertical Cross Section

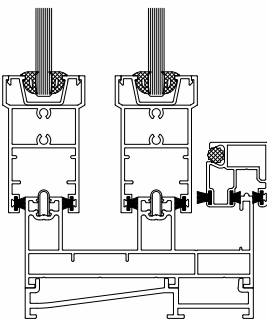

3 Track Sliding Door System with Bigger Mesh

Top Vertical Cross Section

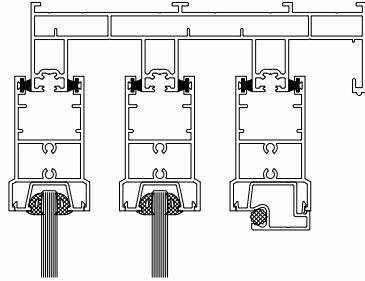

Side Cross Section

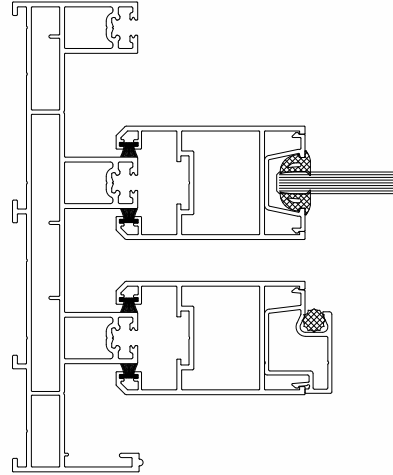

Bottom Vertical Cross Section

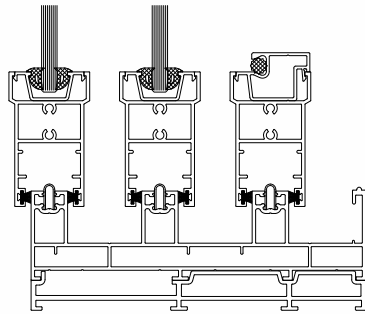

3 Track Sliding Door System

Top Vertical Cross Section

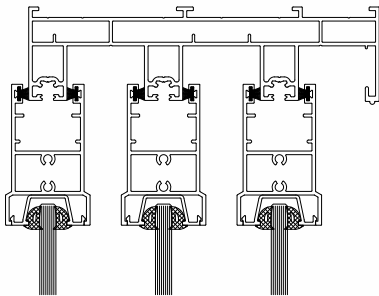

Side Cross Section

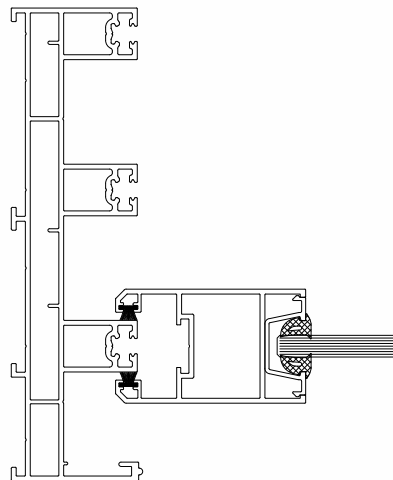

Bottom Vertical Cross Section

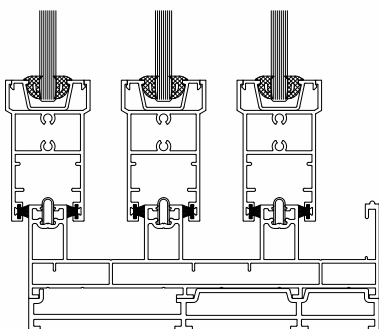

3 Track Sliding Door System with Narrow Mesh

Top Vertical Cross Section

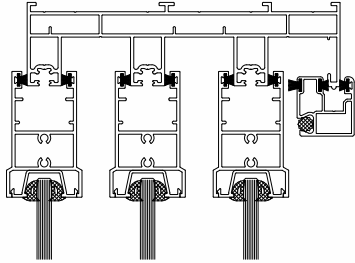

Side Cross Section

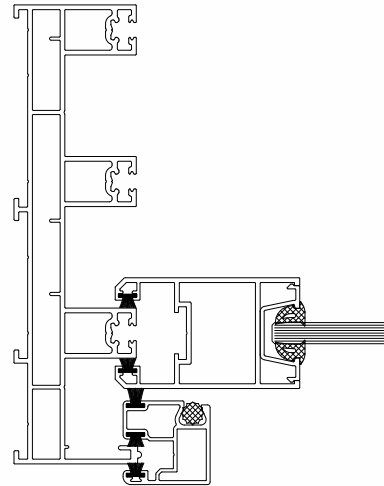

Bottom Vertical Cross Section

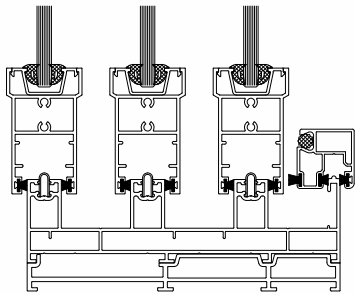

Butt Profile

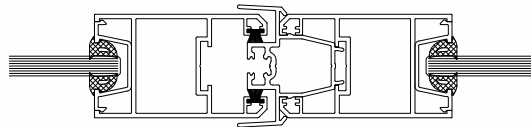

Interlocks

Non Structure Interlock Combination

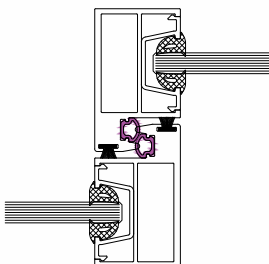

Non Structure & Structure Interlock Combination

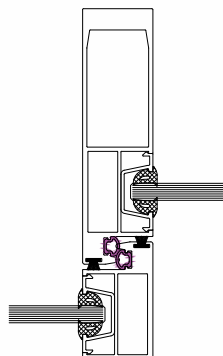

Structure Interlock Combination

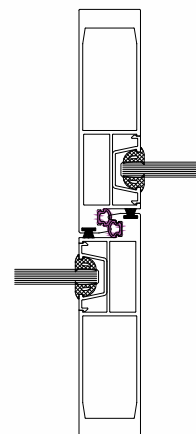



BRILLIANT SURFACES IN COLOUR OR METALLIC EFFECT

POWDER FINISHING FOR THE COLOUR YOU WANT

Thanks to the high quality enamelling of the powder finished profiles, the elements of aluminium retain their original brilliance even after many years and do not need a fresh coat of paint. You can choose from the whole RAL palette with over 200 colours. These RAL colours are available in glossy, matt and textured.

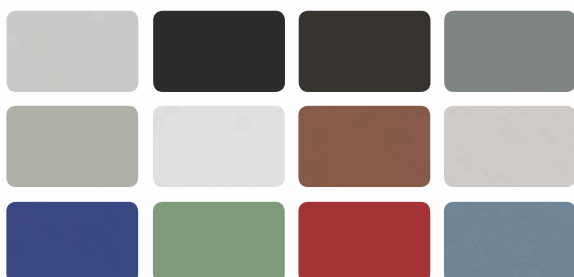

ANODIC FINISHING FOR A BRILLIANT LOOK

The process yields brilliant surfaces and characteristic metallic effects. Anodic finishing is a benefit not only for the look. It also provides long lasting protection against increasingly aggressive environment effects. Furthermore, anodised surfaces are insensitive to mechanical effects and are easy to clean.





ENVIRONMENTAL PROTECTION AND SUSTAINABILITY

Environmental Protection and Sustainability

We think about the entire life cycle of a product and aim to act in an environmentally friendly manner at every step of the way. At profine we see sustainability as our duty in daily operations, our products and manufacturing methods are designed to protect the environment. And we also take our responsibility to society and humanity in general very seriously. All these values make our products an ambassador to eco-friendly environment. Make your commitment to sustainability together with us and our premium window and door systems.

We have made it our goal to position our entire company towards securing a prosperous future for generations to come.



profine India Window Technology Pvt. Ltd.

Registered & Corporate Office
501, 5th Floor, Kailash Building
26, K. G. Marg
New Delhi - 110001
Phone: (+91) 11 42368600
E-Mail: alupure.india@profine-group.com
Website: www.alupure.co.in



profine GmbH

Mülheimer Straße 26
53840 Troisdorf
Germany
Phone: (+49) 2241 9953-0
Fax: (+49) 2241 9953-3561
E-Mail: info@profine-group.com
Website: www.profine-group.com

